

MISTRAL SYSTEM

Set strumenti per impianto steli Mistral
Mistral Stem Implant Instrument Set
 Instrumental para implante de vástago Mistral
 Implantations-Instrumente für Mistral Schäfte

CRL

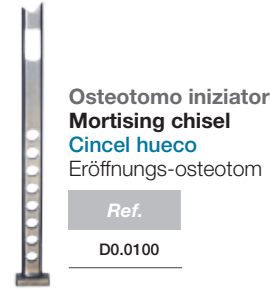
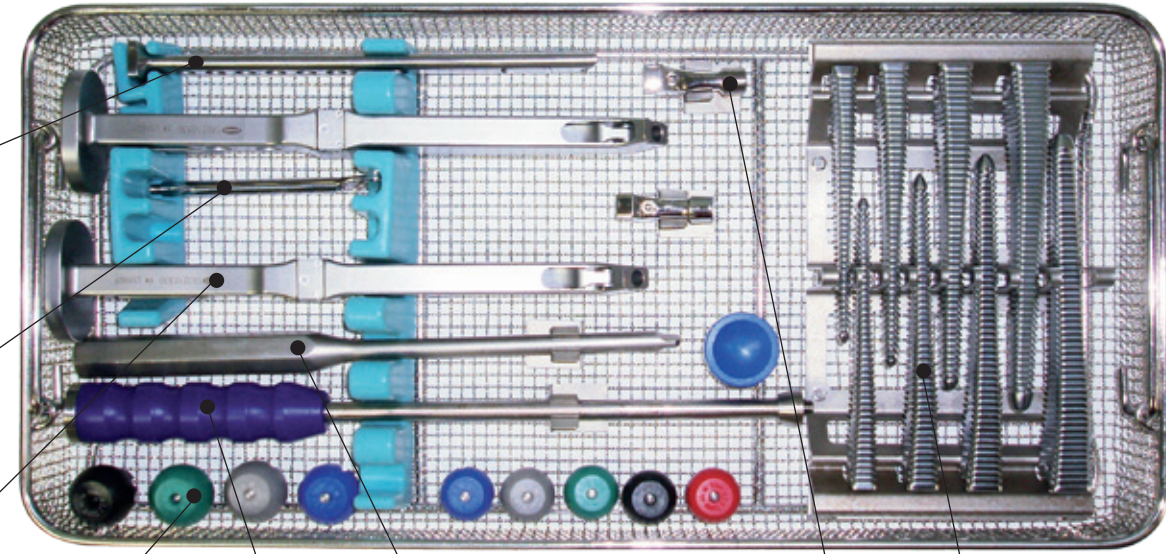

Osteotomo iniziatore
Mortising chisel
 Cincel hueco
 Eröffnungs-osteotom

Ref.
 D0.0100



Riferimento per antiversione
Anteversión reference
 Referencia para anteversión
 Anteversión-Referenzinstrument

Ref.
 SA0040005



Manico per broccia
Broach handle
 Mango para raspa
 Handgriff für räumerkörper

Ref.
 SA0210320



Testina di prova Ø mm 28/32/36/40
Trial head o.d. 28/32/36/40 mm
 Cabeza de prueba Ø mm 28/32/36/40
 Probierköpfe Ø 28/32/36/40 mm

Size	Ref. Ø 28	Ref. Ø 32	Ref. Ø 36	Ref. Ø 40
S	00.ST2810	00.ST3210	00.ST3610*	00.ST4010*
M	00.ST2820	00.ST3220	00.ST3620*	00.ST4020*
L	00.ST2830	00.ST3230	00.ST3630*	00.ST4030*
XL	00.ST2840	00.ST3240	00.ST3640*	00.ST4040*
XXL	00.ST2850			

(*) Prodotto su richiesta
 (*) Product on request

(*) A petición
 (*) Auf Wunsch geliefert



Impattore a mezzaluna
Half moon impactor
 Impactor en forma de media luna
 Halbmondförmiger Impaktor

Ref.
 HTA TA060



Manico impattore
Impactor handle
 Mango impactor
 Schaft für Impaktor

Ref.
 DB.1100 Handle



Broccia
Broach
 Raspa de fresado
 Räumerkörper

Ref.
 SE0210409



Colli di prova
Trial necks
 Cuello de prueba
 Probe-Halsteil

Standard	Offset
Ref.	Ref.
SA0210802	SA0210801

fit SAMO
 Science & Art

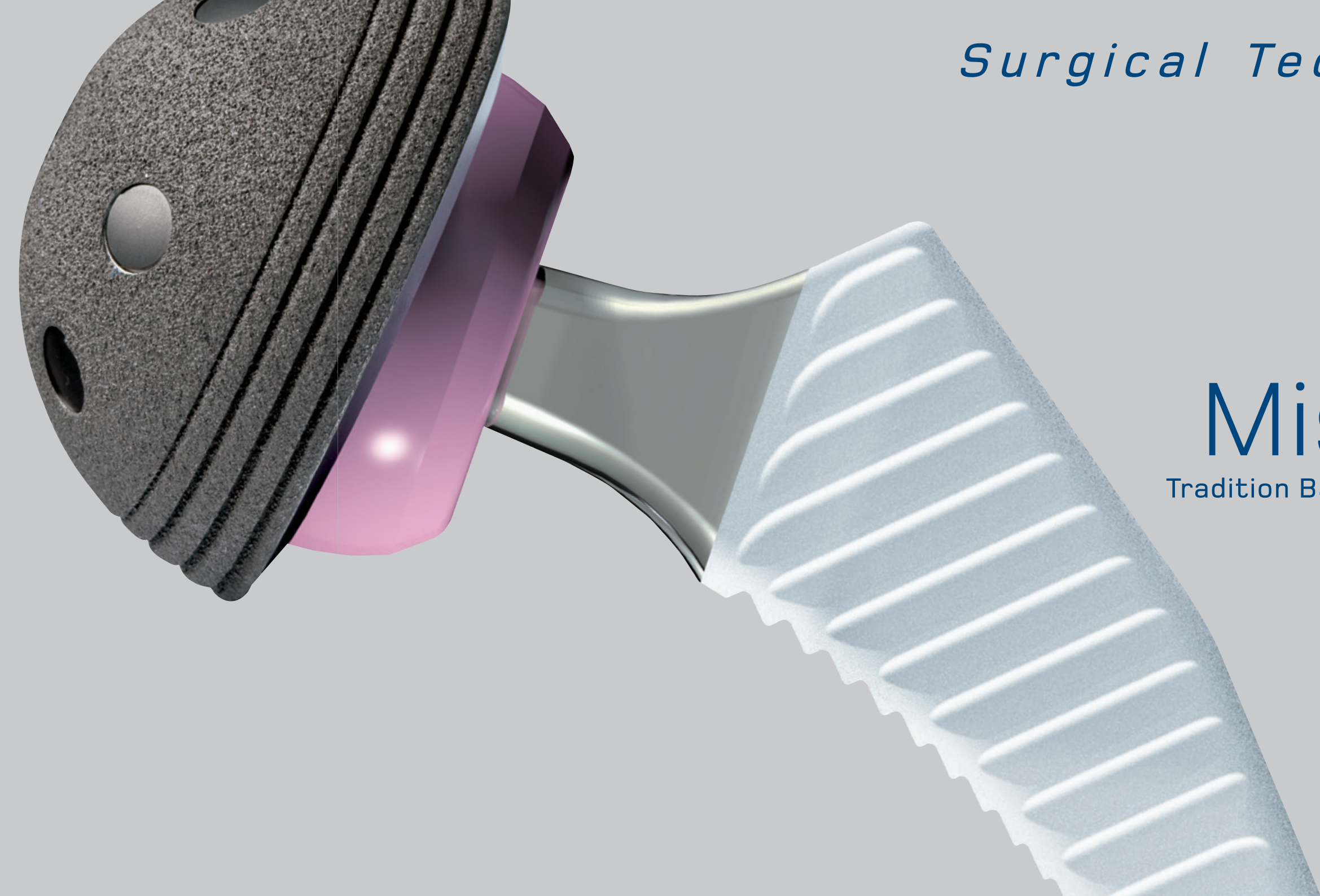

Surgical Technique

Mistral
 Tradition Based Innovation

fit SAMO

samobiomedica.com

PREOPERATIVE PLANNING

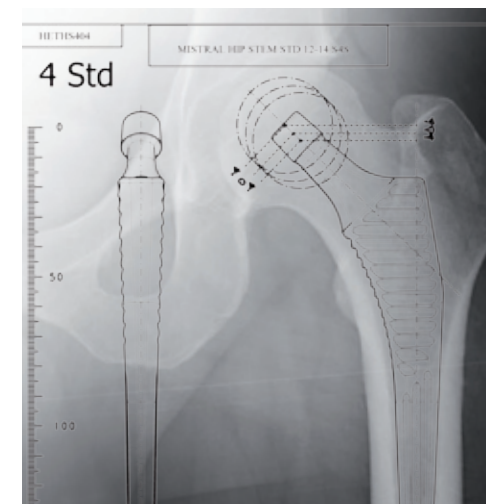

Preoperative planning is of paramount importance in order to correctly address all the specific issues of each particular case, preventing adverse events and needs.

NECK OSTEOTOMY

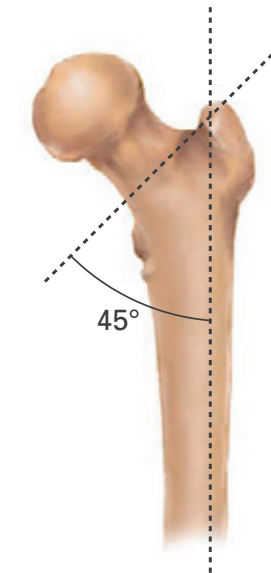

An accurate template allows to precisely determine the level of the neck resection in order to restore a correct ligament tension and center of rotation. Approximately, the resection should be 1 cm above the lesser trochanter. Center the resection guide along the neutral axis of the femur and mark the resection line, then perform the resection.

METAPHYSEAL PREPARATION



The starting osteotome can be used to create a space for the broach insertion. Position the osteotome following the intended version of the final stem.

FEMORAL CANAL PREPARATION



Shape the metaphyseal cavity using the compacting broaches progressively, always starting from the smallest one, pushing each broach down to the level of the resection. The correct size is reached when a complete stability is reached, without reaching cortical contact in the femoral canal. Trace the number of the broach, that matches the sizes of the final implant.

TRIAL NECKS



Trial reductions may be performed by means of the trial necks and trial heads, in order to determine the correct implant configuration for proper joint stability and leg-length. Mistral is available in two stem options: a standard stem (STD) and an high offset lateralized stem (LAT), offering the appropriate neck segment to match up with the stem option.

STEM INSERTION



After introducing the stem by hand into the femoral canal. Ensure that the inserter is correctly coupled with the notch on the top of the implant.

METAPHYSEAL PREPARATION



Pull the implant, gently following the direction dictated by the femoral volume created by the broaches, then impact by hammering along the axis of the femur, until the bone resection is flush to the ha coating border.

FEMORAL HEAD IMPACTION



Carefully clean the Morse cone of the stem, then position the head on the taper. Gently impact the head using the proper head impactor, then reduce the hip.

MISTRAL STANDARD AND LATERALIZED VERSIONS ARE SHOWN



MISTRAL Standard		
Ref.	Size	L (mm) Type A
HETHS401	T1	134
HETHS402	T2	139
HETHS403	T3	144
HETHS404	T4	149
HETHS405	T5	154
HETHS406	T6	159
HETHS407	T7	164
HETHS408	T8	169



MISTRAL Offset Lateralized		
Ref.	Size	L (mm) Type A
HETHL401	T1	134
HETHL402	T2	139
HETHL403	T3	144
HETHL404	T4	149
HETHL405	T5	154
HETHL406	T6	159
HETHL407	T7	164
HETHL408	T8	169

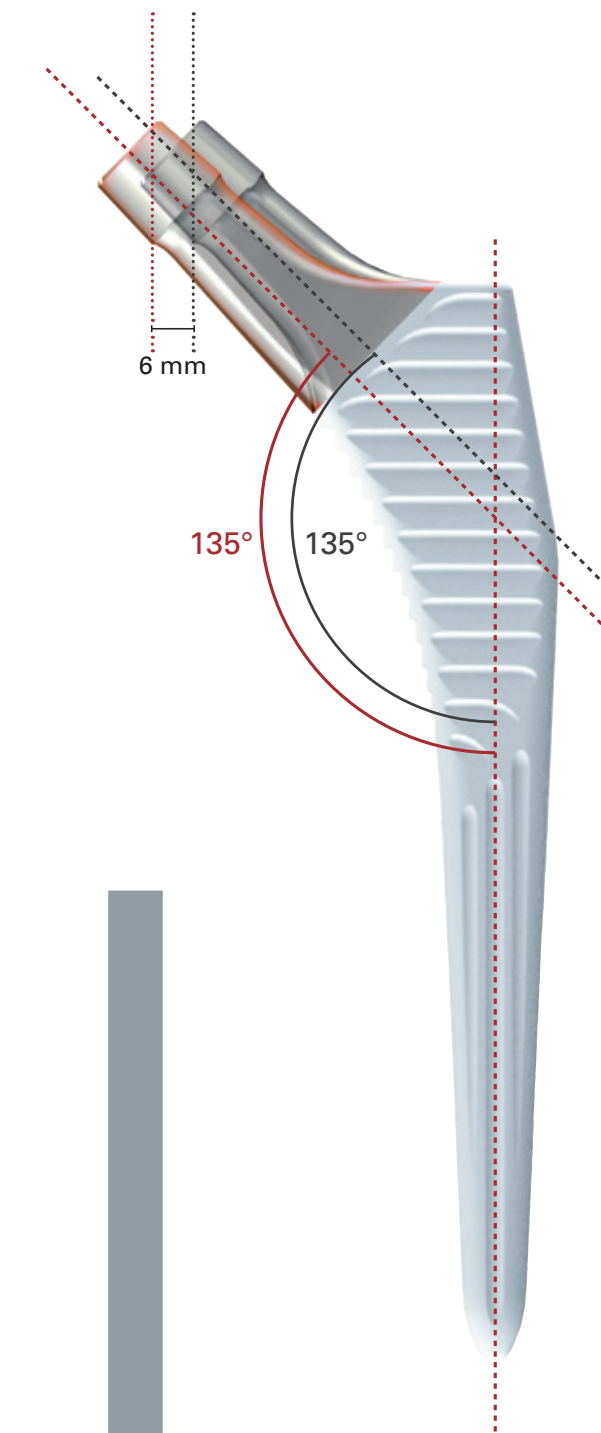

Mistral